

Wolfenden Concrete Ltd.

Eden Works,
Colne Road,
Kelbrook,
Lancashire
BB18 6SY

Tel:- 01282 844213

Fax:- 01282 843336

Data Sheet : *Retaining Wall Panels*

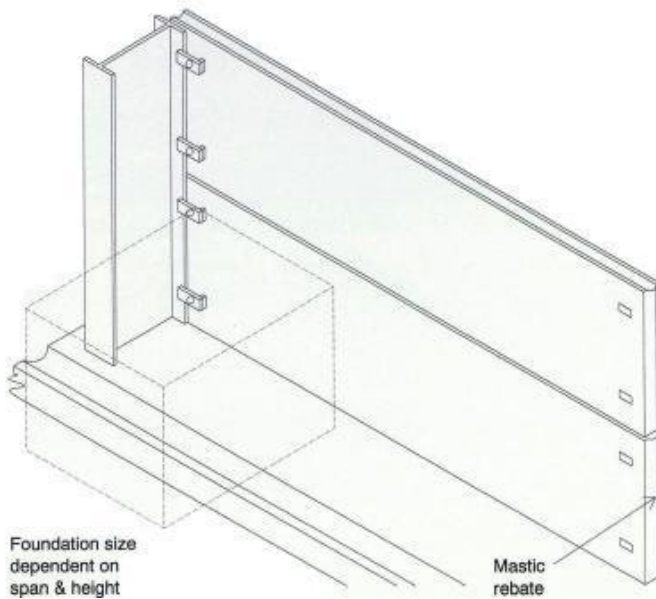

90mm width for building walls
140mm width for load-bearing walls

Individual Unit Sizes

Spans: up to 6100mm

Heights: 550mm
 1000mm
 1200mm
 1500mm

Width: 140mm
 90mm

Retaining Wall Panels can be used to swiftly erect strong concrete walls, perfect for crop storage, earth retaining or stock divisions.

Panels are manufactured with a tongue & groove horizontal joint which allows easy sealing to form a water-proof wall. Dense high-strength concrete allows for easy cleaning of the walls giving hygienic conditions.

No foundations required, simply sat on landing cleat on the supporting steelwork. All loadings are transferred to the steelwork. The universal fixing design requires no drilling, allowing flexibility in your building design, e.g. siting of doorways etc.

